

\\1751\3800\7824_natchitoches fire station\2.preliminary plan\c-civil\7824_site_plan
2025.03.14 14:42:11 PM

A
B
C
D

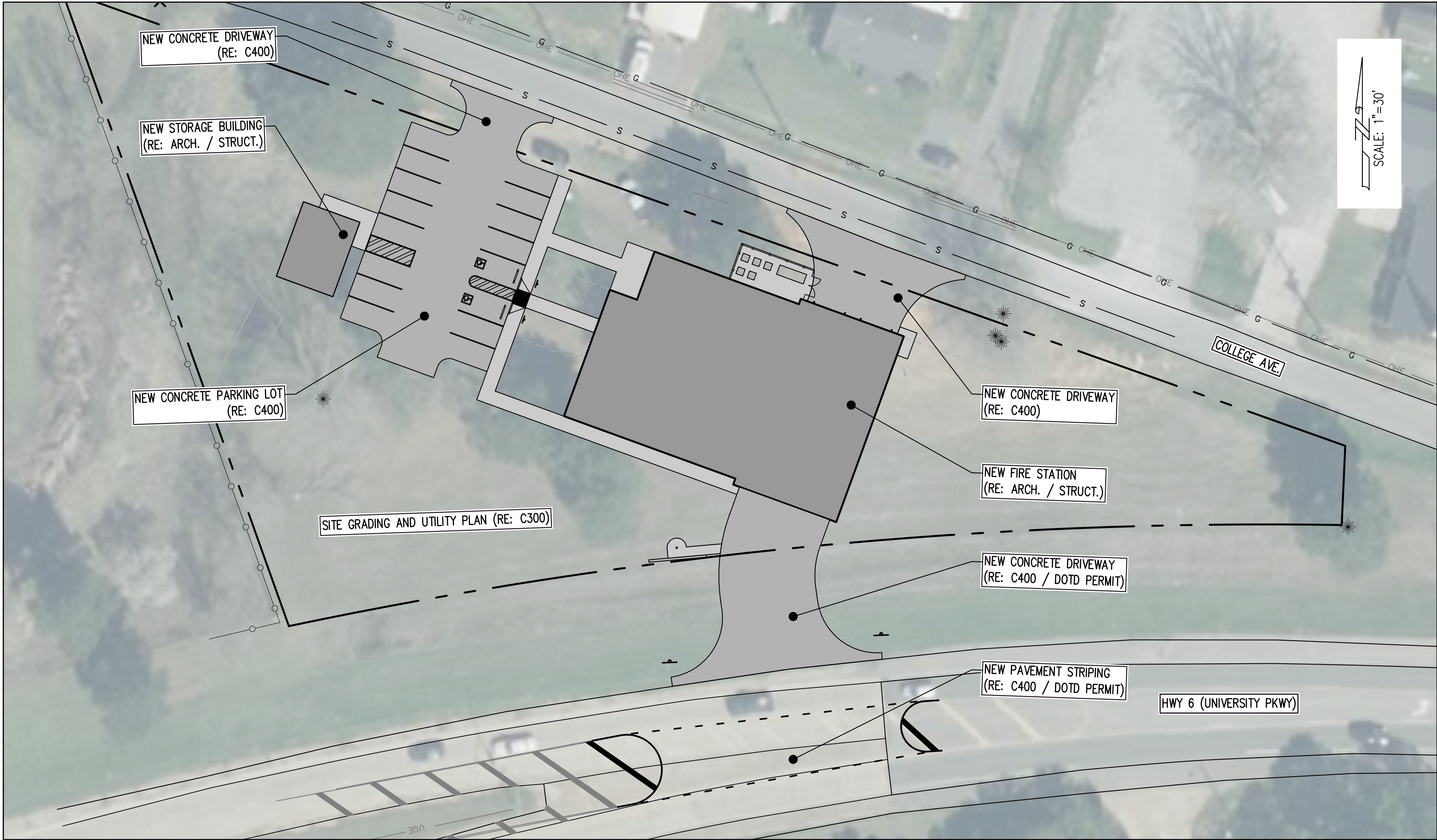

1
C200

OVERALL SITE PLAN

SCALE: 1" = 30'-0"

NOTES:

1. REFERENCE SHEET C201 FOR SITE LAYOUT COORDINATES.
2. TEMPORARY BENCH MARKS SHOWN ON SHEET C201.

GENERAL NOTES:

1. CONTRACTOR IS RESPONSIBLE FOR CONTACTING "LOUISIANA ONE CALL (DOTTIE)" [1-800-272-3020] AND VERIFYING THE LOCATION OF ALL UTILITIES IN THE AREA PRIOR TO CONSTRUCTION. EXTREME CAUTION SHALL BE USED TO NOT DAMAGE EXISTING UTILITIES. CONTRACTOR SHALL BE RESPONSIBLE FOR REPAIRING ALL EXISTING UTILITIES THAT ARE DAMAGED BY CONTRACTOR'S WORK. CONTRACTOR SHALL CONTACT ENGINEER AND OWNER WHEN EXISTING UTILITIES CONFLICT WITH PROPOSED CONSTRUCTION.
2. MATERIALS AND CONSTRUCTION SHALL BE IN ACCORDANCE WITH THE STATE OF LOUISIANA DOTD STANDARD SPECIFICATIONS FOR ROADS AND BRIDGES, LATEST EDITION WHEN REFERENCED.
3. CONTRACTOR SHALL PROVIDE BARRICADES, FLAGMEN, AND OTHER SAFETY MEASURES AS REQ'D. CONTRACTOR TO PROVIDE SAFETY MEASURES IN ACCORDANCE WITH LADOTD STANDARD SPECIFICATIONS FOR ROADS AND BRIDGES, LATEST EDITION.
4. DE-GRASS AS REQ'D (8" THICK MIN.) AND STOCKPILE FOR LATER RE-USE. CONTRACTOR TO PLACE DE-GRASSED MATERIAL OVER FINISHED GRADE PRIOR TO HYDRO-SEEDING.
5. THE CONTRACTOR IS RESPONSIBLE FOR PROTECTING EXISTING BENCHMARKS AND RELOCATING BENCHMARKS IF NECESSARY. DISTURBED BENCHMARKS SHALL BE RELOCATED TO ORIGINAL ELEVATION.
6. CONTRACTOR SHALL PROVIDE SOIL EROSION AND SEDIMENTATION CONTROL MEASURES, INCLUDING DEVICES AND PROCEDURES FOR THE EXPRESSED PURPOSE OF PREVENTING SOIL EROSION AND/OR DEPOSITION OF SEDIMENTATION. THE CONTRACTOR SHALL COMPLY WITH U.S. ENVIRONMENTAL PROTECTION AGENCY REGULATIONS UNDER THE NATIONAL POLLUTION DISCHARGE ELIMINATION SYSTEM (NPDES) AND THE STORM WATER POLLUTION PREVENTION PLAN (SWPPP).
7. CONTRACTOR SHALL USE BEST MANAGEMENT PRACTICES TO MINIMIZE AIR POLLUTION AND WIND EROSION DURING CONSTRUCTION INCLUDING, BUT NOT LIMITED TO, SPRAYING OF WATER ON EXPOSED SOILS, COMPACTION OF FILL, PAVING, OR REVEGETATING IMMEDIATELY AFTER GRADING OPERATIONS.
8. ANY REQUIRED EXTENSIONS TO, OR ADDITIONAL MEASURES AND PROCEDURES, BEYOND THOSE SHOWN OR DESCRIBED, TO ADEQUATELY CONTROL OR CORRECT EROSION CONDITIONS THAT MAY DEVELOP DURING CONSTRUCTION, THAT WERE NOT FORESEEN DURING THE DESIGN OF THE PROJECT SHALL BE INCORPORATED BY THE CONTRACTOR AT NO ADDITIONAL COMPENSATION.
9. DISPOSAL AREAS, STOCKPILES AND HAUL ROADS SHALL BE CONSTRUCTED IN A MANNER THAT WILL MINIMIZE AND CONTROL THE AMOUNT OF SEDIMENT THAT MAY ENTER RECEIVING WATERS. THESE AREAS SHALL BE SITUATED SO AS NOT TO OBSTRUCT NATURAL DRAINAGE AND TO MINIMIZE THE RUNOFF OF POLLUTANTS.
10. ANY OFFSITE AREAS DISTURBED DURING CONSTRUCTION SHALL BE RE-GRADED, SEEDED AND FERTILIZED, GRASSED AND RESTORED TO PRECONSTRUCTION CONDITION OR BETTER.
11. CONTRACTOR MAY UTILIZE AN ONSITE CONCRETE TRUCK WASHOUT AREA. WASHOUT AREA SHALL BE SHAPED TO CONTAIN WASHOUT AND SHALL BE LINED WITH 11 MIL (MIN.) VISQUEEN OR HDPE LINER. DRIED MATERIALS AND LINER SHALL BE REMOVED FROM SITE PRIOR TO FINAL GRADING.



MEYER, MEYER, LACROIX & HIXSON, Inc.
ENGINEERS & LAND SURVEYORS
ALEXANDRIA, LOUISIANA

PROJ. NO. **7824** DATE: **7/11/25**

DESIGN: **WLM** DRAWN: **GO**

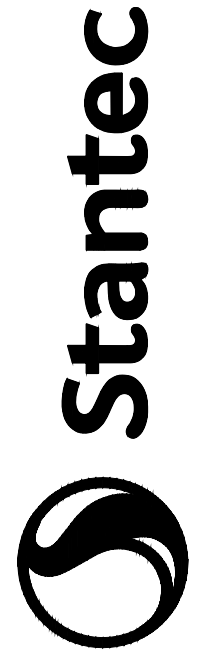

Stantec [Formerly Bradley-Blevins & Associates]
1200 Bickyard Lane, Suite 400
Baton Rouge, LA 70802
Tel: 225-765-7400
www.stantec.com

Copyright Reserved

The Contractor shall verify and be responsible for all dimensions. DOTD notes the
The Contractor shall verify and be responsible for all dimensions. DOTD notes the
The Contractor shall verify and be responsible for all dimensions. DOTD notes the
The Contractor shall verify and be responsible for all dimensions. DOTD notes the
The Contractor shall verify and be responsible for all dimensions. DOTD notes the

Consultant

YYTJAMJDD

Asst

By

Revision

Design Phase Acceptance

Permit/Seal

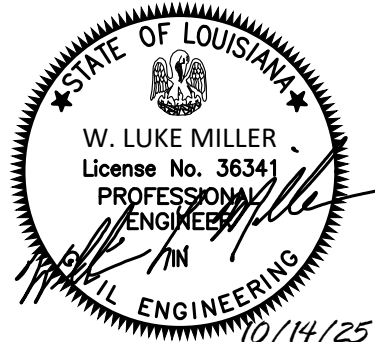

Client/Project
CITY OF NATCHITOCHES

NEW FIRE STATION NO. 3

NATCHITOCHES, LOUISIANA

Project No.: 222706059

File Name: 7824_SITE_PLAN

Scale: 1" = 30'-0"

Dwn. Dign. Chkd. 2025.09.26
YYYY.MM.DD

Title **OVERALL SITE PLAN
& GENERAL NOTES**

Revision: Sheet: of
Drawing No. **C200**